

KombiSIGN 71 / WIN

## WIN ethernet receiver 115-230VAC BK

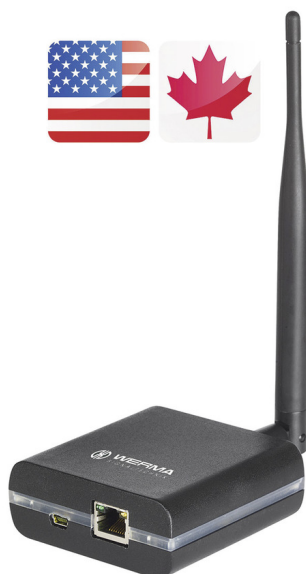

Part No.: 860.000.07



### MECHANICAL DATA

Length	80 mm
Width	76 mm
Height	30 mm
Materials	ABS
Housing colour	Black
Protection category	IP20
Connection	USB
Working temperature minimum	0°C
Working temperature maximum	+40°C
Weight with packaging	494 g
Product weight	436 g

### ELECTRICAL DATA

Operating voltage	115-230V
Operating voltage type	AC
Operating voltage frequency	50Hz at 230V 60Hz at 115V
Operating voltage tolerance	+/- 10%
Rated operational voltage	230 VAC
Rated operational current	160 mA
Rated inrush current	800 mA
Protection class	Protection class 2
Pollution degree	2
Overvoltage category	II
Isolation voltage	Ui = 250V; Uimp = 2.500V
connectivity	Ethernet WIN

### APPROVAL DATA

Conforms with CE	No
Conforms with RoHS directive	Fulfills substance restriction
WEEE	Yes
Conforms with ATEX-directive	No
Conforms with CCC	No
Conforms with UL	No
Conforms with FCC	Yes
Conforms with IC	Yes
EAC certificate available	Yes
Conforms with AS-I	No



For additional installation and mounting information, refer to the appropriate user guide at [www.werma.com](http://www.werma.com). This printed copy is for information only and is subject to alteration.

KombiSIGN 71 / WIN

## WIN ethernet receiver 115-230VAC BK

ICAO Certification	No
Conforms with DNV	No
Conforms with RoHS CN	No
Conforms with VdS	No

### DRAWING

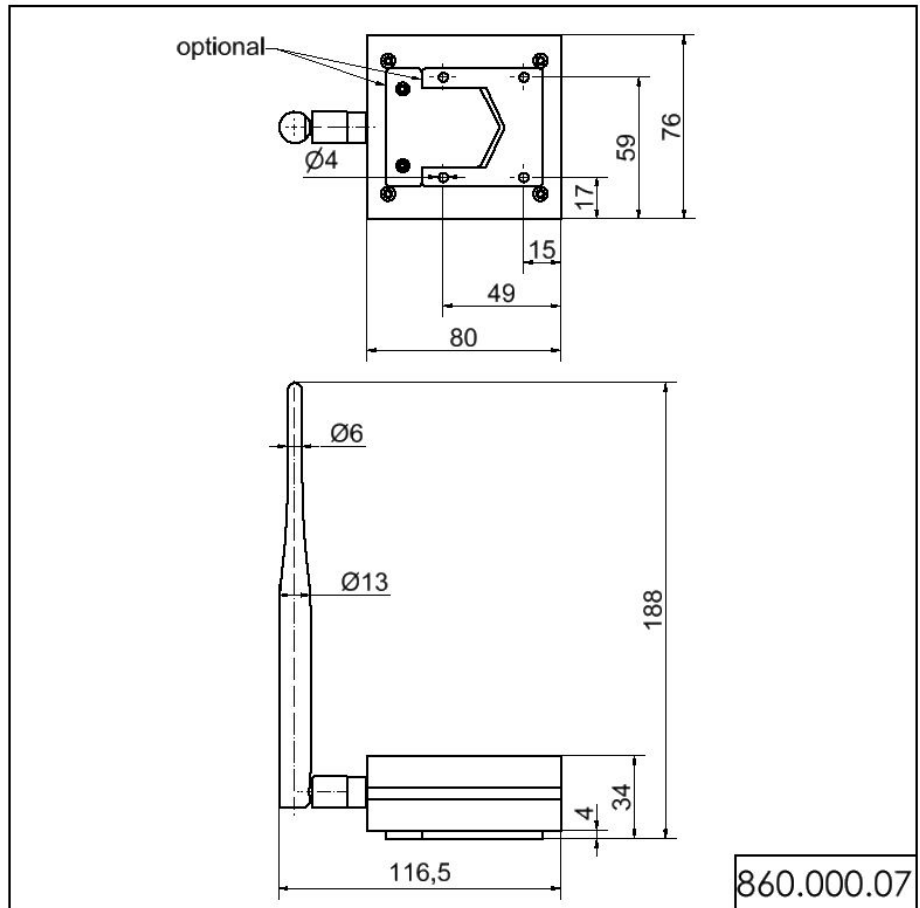

For additional installation and mounting information, refer to the appropriate user guide at [www.werma.com](http://www.werma.com). This printed copy is for information only and is subject to alteration.